

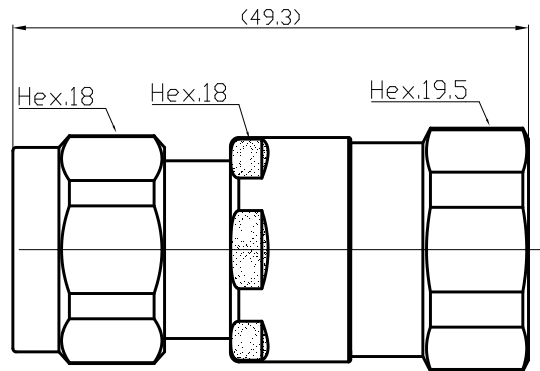

1. Figure



2. Product Description

NM-1/2"L

N Straight male Connector for 1/2" Flexible RF Cable

3. Material and Plating

Pin-Centre contact	Brass / Silver Plated
Outer contact & Body	Brass / Trimetal Plated
Dielectric	TPX/PTFE
Gasket	Silicon Rubber
Nut	Brass / Nickel Plated

4. Electrical Characteristics

Characteristics Impedance	50 Ohm	
Insulation Resistance	≥5000MΩ	
Centre contact resistance	≤1.00 mΩ	
Outer contact resistance	≤0.25 mΩ	
Dielectric Withstanding Voltage	2000V rms(AC)	
Insertion Loss	@690-960 MHz	≤0.10dB
	@1700-2700 MHz	≤0.15dB
	@2700-3000 MHz	≤0.20dB
	@3000-5000 MHz	≤0.25dB
VSWR	@690-960 MHz	≤1.10
	@1700-2700 MHz	≤1.13
	@2700-3000 MHz	≤1.15
	@3000-5000 MHz	≤1.20
PIM3(@2x20W,1800MHz,static state)	≤-155dBc	

5. Environmental and Mechanical Specifications

Gauge retention force	
Centre contact	/
Outer contact	/
Coupling nut torque	0.7-1.1 N·m
Coupling nut retention force	≥250 N
Durability (matings)	≥500 cycles
Axial holding force of center conductor	28 N
Shock	As per std:IEC 60068-2-27/GB/T 2423.5
Vibration	As per std:IEC 60068-2-6/GB/T 2423.10
Salt mist	As per std:IEC 60068-2-11/GB/T 2423.17(48H)
Temperature Range	-45°C to +85°C
RoHS	Compliant
Sealing Class	IP68