

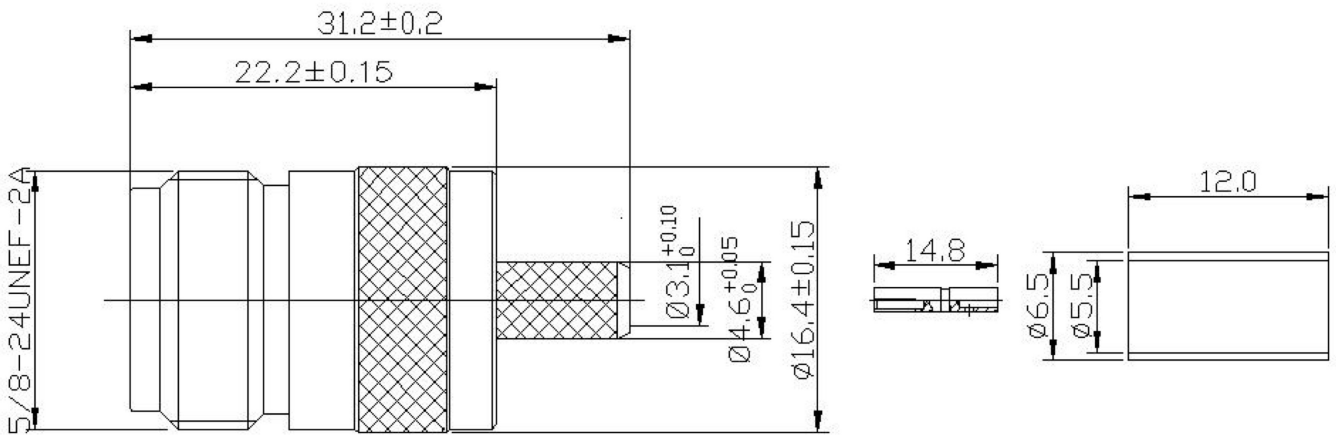

# Product Specifications

NF-KSR195



Dimensions in mm

## 1 Product Structure

|   | Designation     | Material        | Plating        |
|---|-----------------|-----------------|----------------|
| 1 | Inner Conductor | Brass           | Gold- Plated   |
| 2 | Insulator       | PTFE            | -              |
| 3 | Body            | Brass           | Nickel- Plated |
| 4 | Gaskets         | Silicone Rubber | -              |
| 5 | Crimp           | Brass           | Nickel- Plated |

## 2 General Specifications

|            |                    |
|------------|--------------------|
| Interface  | N female           |
| Standards  | IEC61169、IEC 60169 |
| Body Style | Straight           |
| Durability | ≥ 500              |
| Cable      | KSR195             |

## 3 Electrical Specifications

|                                 |                     |
|---------------------------------|---------------------|
| Impedance                       | 50Ω                 |
| Operating Frequency Band        | DC-3GHz             |
| Insertion Loss, Typical         | ≤0.05√f dB Max      |
| VSRE                            | ≤1.25; ≤1.35@3~6GHz |
| Dielectric withstanding voltage | 1000V               |
| Contact Resistance              |                     |
| Inner Conductor                 | ≤1.5mΩ              |
| Outer Conductor                 | ≤2.0mΩ              |
| Insulation Resistance           | ≥5000MΩ             |

## 4 Environment Specifications

|                                  |                               |
|----------------------------------|-------------------------------|
| Operating Temperature            | -40°C to +85°C                |
| Corrosion Test Method            | IEC 60068-2-52 48h            |
| Damp Heat Resistance Test Method | IEC 61169-1, Sub-clause 9.4.3 |
| Thermal Shock Test Method        | IEC 61169-1, Sub-clause 9.4.4 |
| Vibration Test Method            | IEC 61169-1, Sub-clause 9.3.3 |
| Mechanical Shock Test Method     | IEC 60068-2-27                |